

Key with map to guide participant set up and tear down

Heavy Equipment
In Mon 7 am to 12 PM
Out Thurs. 4–5 PM

Other Exhibits, Listening Post
In Monday: 12 to 3 pm,
Out Thursday: 3:30 PM

Presentation Stage
Day of only
20 minutes before and after start and end time

Conferences
Day of:
Between session start and end time

First Level:

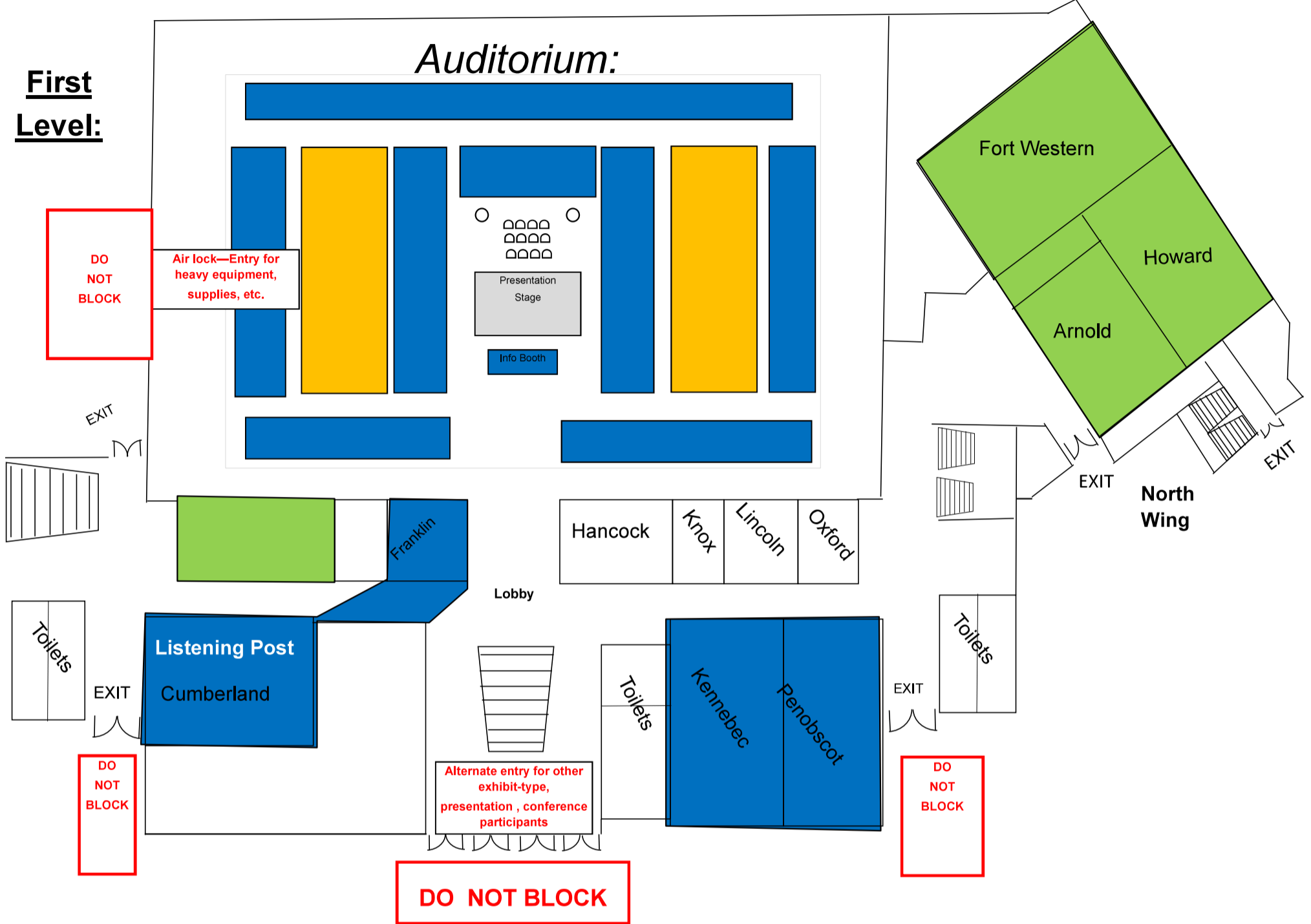

Second Level:

